

1094.80.I4.L/R STILETTO-E Easy Lift

Hinge specifications

Door weight:	120kg. Must be mounted with 1094.80.089L/R
Operating temperature:	-20 to +60°C
Materials:	Brushed Stainless steel
Corrosion resistance class:	Class 4 (EN 1670: 2007 + AC:2008)
Connection cable:	With terminal Block Push in (with screwdriver) Section min 0.14mm ² , max 1.5mm ²
Electrical signal:	Pin 1 = 3A x50Vdc Pin 2 = 3A x50Vdc Pin 3 = 1A x50Vdc Pin 4 = 1A x50Vdc

Electrical signal value allowed by pin

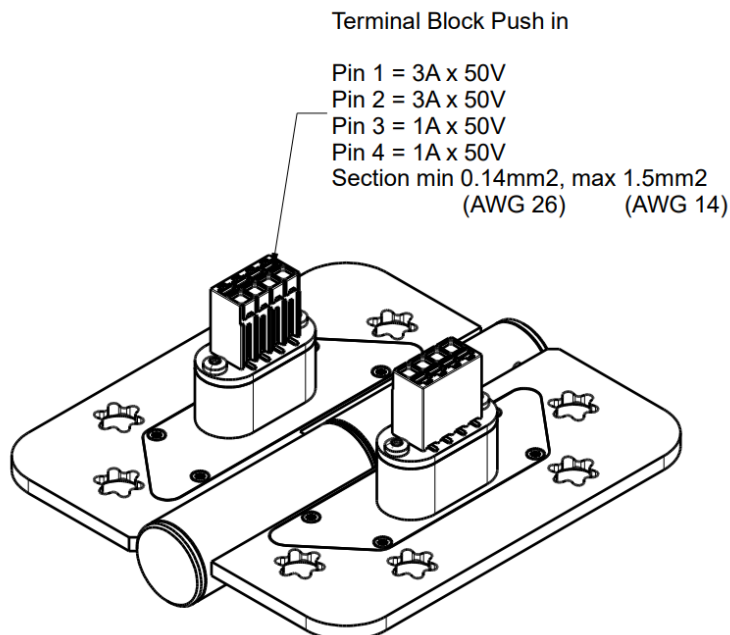

Safety Informations

- The wiring work must be done by a professional
- The maximum current per wire must not exceed 3A 50Vdc for pin 1 and 2, 1A 50Vdc for pin 3 and 4 
- This hinge is only passive. The end user must perform EMC testing to ensure compliance of the product.

Drawings

1094.80.089.I4.L

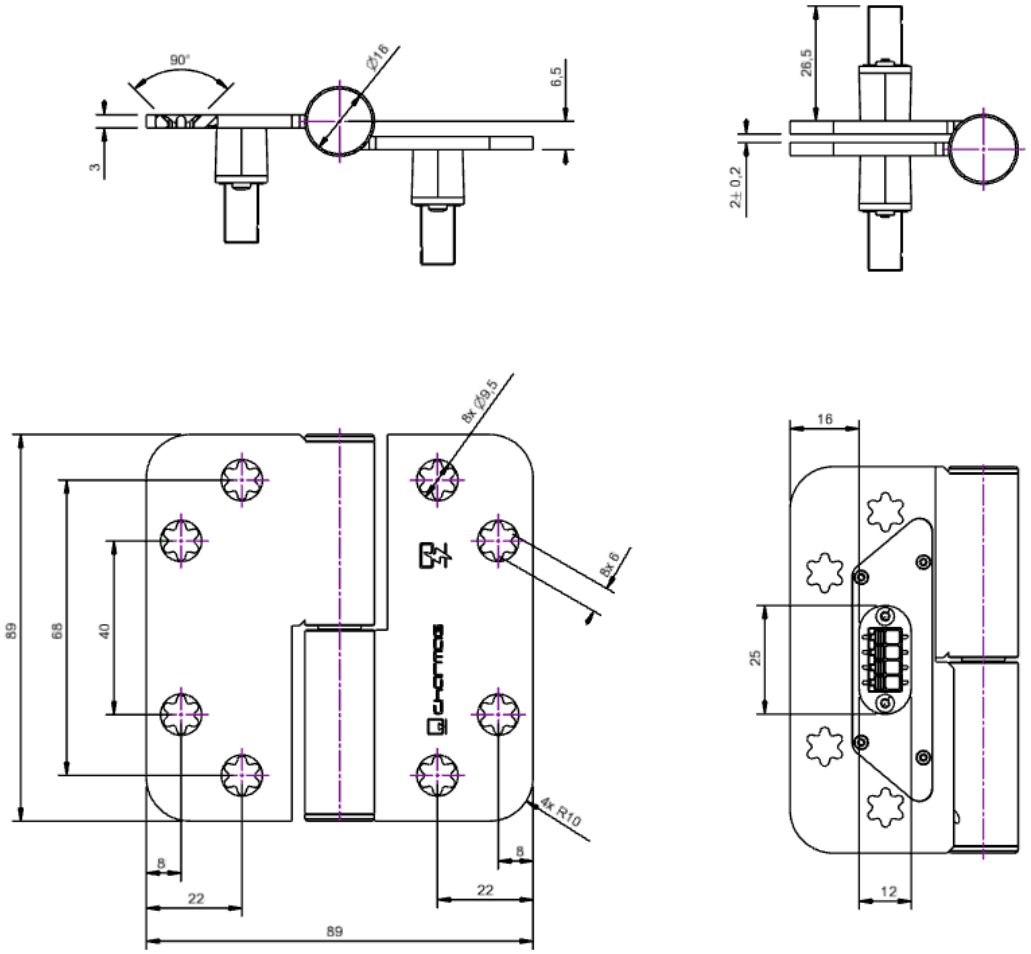

1094.80.089.I4.R

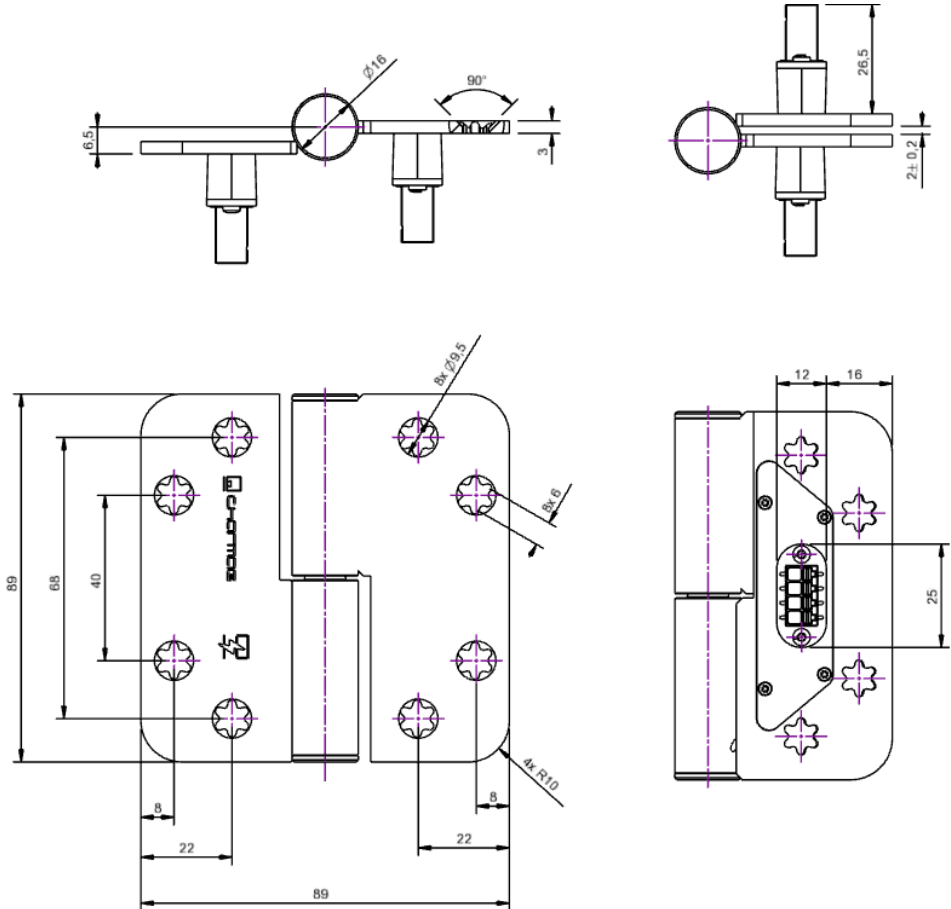

Recommended installation

Standard hinge
1094.80.089



Electrical hinge
1094.80.089.I4

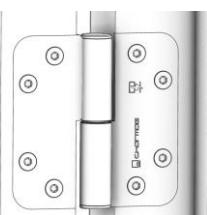

Standard hinge
1094.80.089

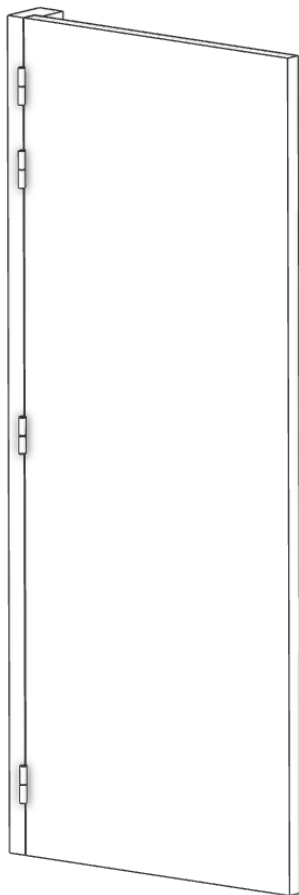

Montagehandleiding

FH Kogelstift paumelles Type 1094.XX.XXX

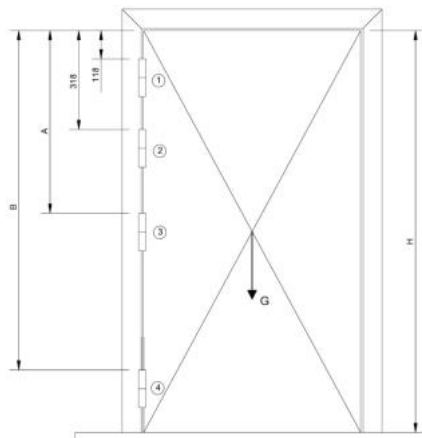

Plaatsbepaling van paumelle volgens BRL 0803 vanaf bovenkant deur (maten in mm)

SKG**, Klasse 2



3 Paumelles,

Optie 1: posities 1,2,4

Optie 2: posities 1,3,4

Schroefmaten in naaldhout minimaal 4X40 mm

Schroefmaten in loofhout minimaal 4X30 mm

SKG***, Klasse 3



4 Paumelles,

Per Paumelle 8 schroeven, minimaal

4,5X45 mm, skh gecertificeerd

Deurhoogte	Paumelle 1	Paumelle 2	Paumelle 3	Paumelle 4
2015 – 2199	118	318	958	1798
2200 – 2299	118	318	1058	1948
2300 – 2399	118	318	1158	2048
2400 – 2499	118	318	1258	2148
2500 – 2599	118	318	1358	2248
2600 – 2699	118	318	1458	2348

Profil machining

Standard hinge
1094.80.089

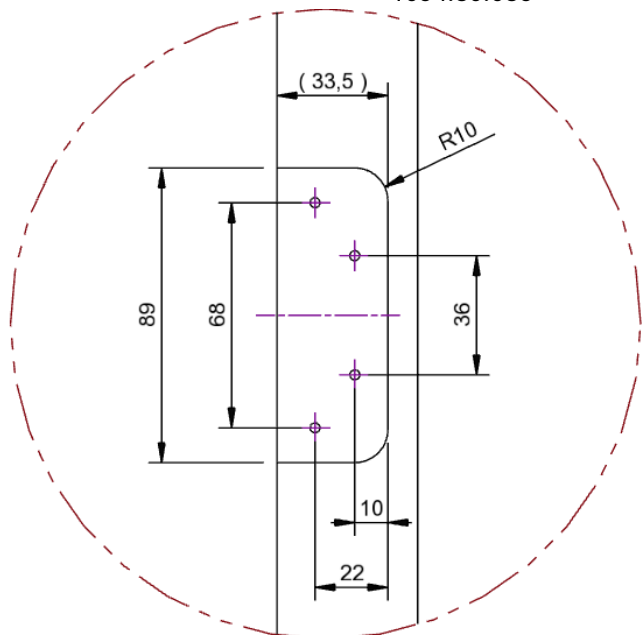

Electrical hinge
1094.80.089.I4

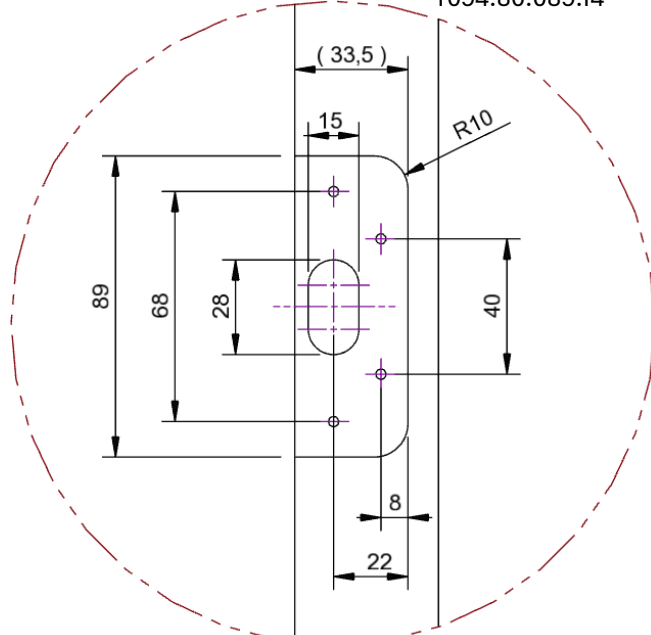

Final product inspection

**The transmission of the
4 poles is checked at
100% by Charmag on all
product.**

Date

_____ . _____ . _____

Visa:
